

# RAMMER 555E



EXCELLENCE LINE

FACTORY  
INSTALLED  
RD3 FOR  
MYFLEET

CBE (CONSTANT  
BLOW ENERGY)

MEMBRANE TYPE  
ACCUMULATORS

SINGLE BODY DESIGN  
WITHOUT TIE RODS

INTEGRATED TOOL BUSHINGS  
AND THRUST RING (3 IN 1)

## EXCELLENCE LINE HITS SMARTER

The Rammer Excellence Line is a set of state-of-the-art hydraulic hammers for all your rock breaking needs. All Excellence Line hammers now have integrated smart technology for easier fleet management and more efficient processes.

Read more about the product from  
[www.rammer.com/excellence](http://www.rammer.com/excellence)

**Ram  
mer**<sup>®</sup>

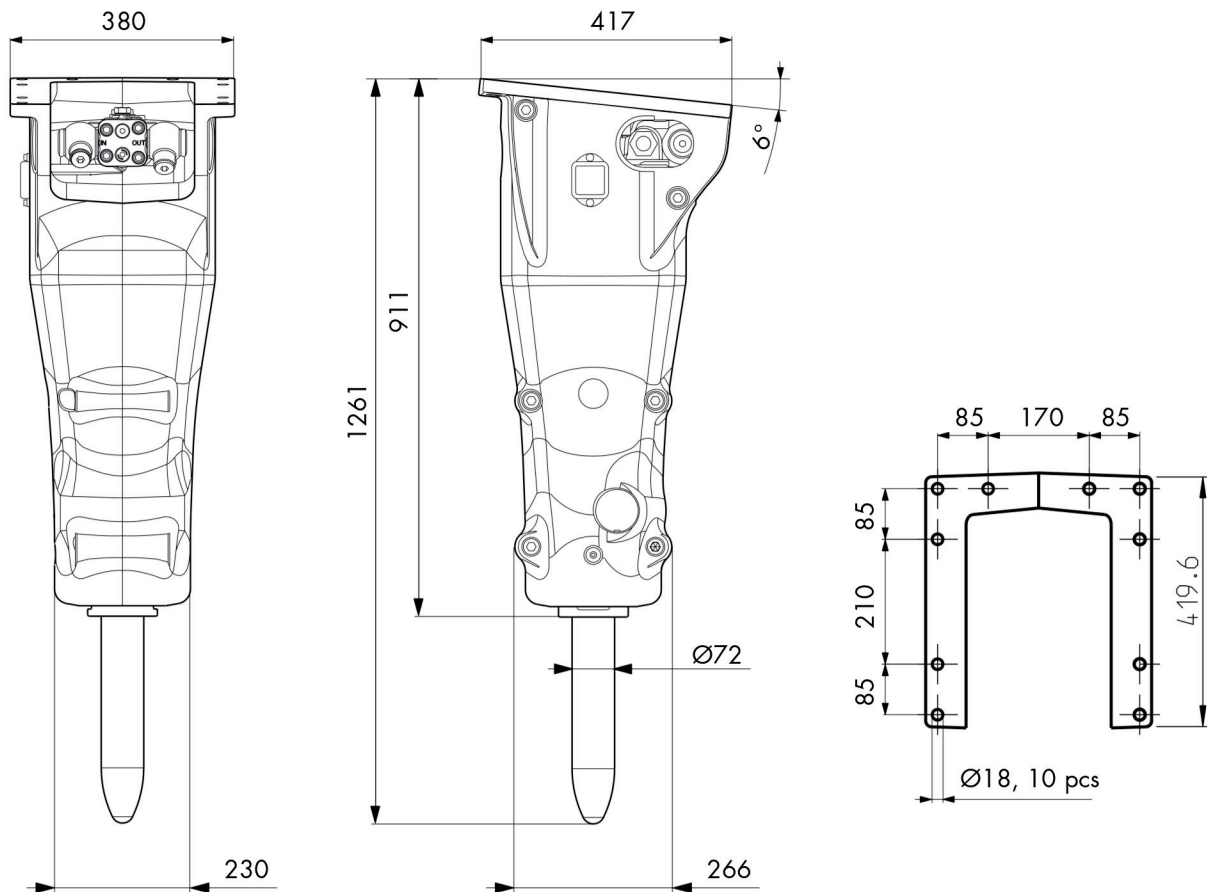

## SPECIFICATIONS

Minimum working weight, flange mounted, kg (lb)	275 (610)
Impact rate, bpm	600-1800
Operating pressure, bar (psi)	90-140 (1305-2030)
Pressure relief, max bar (psi)	220 (3190)
Oil flow range, l/min (gal/min)	35-90 (9.2-23.8)
Back pressure, max bar (psi)	20 (290)
Input power, kW (hp)	21 (28)
Tool diameter, mm (in)	72 (2.83)
Min excavator weight, allowed range t (lb)	3.2-8.0 (7100-17600)
Skid steer, robot weight, allowed range t (lb)	1.9-5.3 (4200-11700)
Noise level, measured sound power level, LWA dB	118
Noise level, guaranteed sound power level, LWA dB	122

## TOOLS

Chisel  
Pyramid  
Moil point

Spade  
Compacting plate

## PARTS

Service kit 1  
Special tool grease

Specifications are subject to change without notice



**Sydney**  
Ground Tec Equipment  
16 Garema Cct, Kingsgrove NSW 2208

**Newcastle**  
Ground Tec Equipment  
27 Jura St, Heatherbrae NSW 2324



Contact : 02 9642 2030 / breakers@groundtec.com.au